

SOLUTIONS IN BULK HANDLING



Transportation containers hold from 60 to 550 gallons.

UN/DOT-APPROVED IBCs

Snyder intermediate bulk containers (IBCs) are durable, corrosion-resistant and economical. These long-term, reusable containers are ideal for the transportation of both hazardous and non-hazardous liquid materials.



Stationary tanks store from 8 to 16,500 gallons.

BULK STORAGE & PROCESSING TANKS

For larger stationary applications, Snyder offers the industry's broadest range of tanks – from 8 to 16,500 gallons – in shapes that meet your specific needs. To match your special function requirements, we also market a complete line of accessories, such as stands, seismic tie-downs, ladders, fittings, gaskets, sight gauges, heat tracing and insulation.



Captor Tank Systems available from 550 to 6,500 gallons.

DOUBLE-WALL TANKS (BULK STORAGE)

For larger double-wall applications, Snyder offers its line of Captor[®] Tank Systems from 550 to 6,500 gallons. These tanks, like the smaller double-wall tank systems, provide 115% secondary storage capacity. Captor tanks are available with top and bottom sidewall outlets, ladders, seismic tie-down systems, heat tracing and insulation, ultrasonic level and leak detection sensors.

ONE SOURCE DOES IT ALL

Whether you are a manufacturer or distributor, Snyder Industries can help you improve the function, economics and performance of your company's bulk handling systems.



SOLUTIONS IN BULK HANDLING

P.O. Box 4583 • Lincoln, Nebraska 68504 • 402-467-5221 • FAX: 402-465-1220 • www.snydernet.com

Other manufacturing facilities:

Marked Tree, Arkansas • Chowchilla, California • Philippi, West Virginia

Printed 3/05

DOUBLE-WALL TANK SYSTEMS

Unique tank-within-a-tank containment system provides maximum performance and material handling options in many space saving configurations.



SOLUTIONS IN BULK HANDLING

Enjoy Enhanced Operational and Environmental Safety with the Double-Wall Tank System from Snyder—the Industry Leader.



Snyder Tanks are molded with a variety of polyethylene materials, including FDA and NSF 61 compliant high-density (HDLPE) and cross-linked high-density (XLPE) resins. Snyder Industries' tank engineering team is responsible for a multitude of poly tank

processing and design patents, which are utilized to produce plastic tank solutions that *exceed the safety and performance requirements of our customers at the lowest possible cost.*

Snyder's latest product innovation, double-wall tanks ranging from 35 gallons up to 500 gallons, provides a primary and secondary containment solution in one integral space saving unit. The smaller design configurations are ideal for commercial "Day" tank system requirements, and can be used in conjunction with Snyder's extensive line of larger

double-wall, bulk storage tanks up to 6,500 gallons (Captor Containment Systems). The system's double-wall design means twice the security when storing and handling potentially dangerous chemicals.

With a variety of sizes from which to choose, and features such as doorway-compatible narrow diameters (available on tanks up to 150 gallons) and forklift channels (available on the larger 275, 360 and 500 gallon sizes), there's a Double-Wall Tank System that's ideal for virtually any liquid handling application.

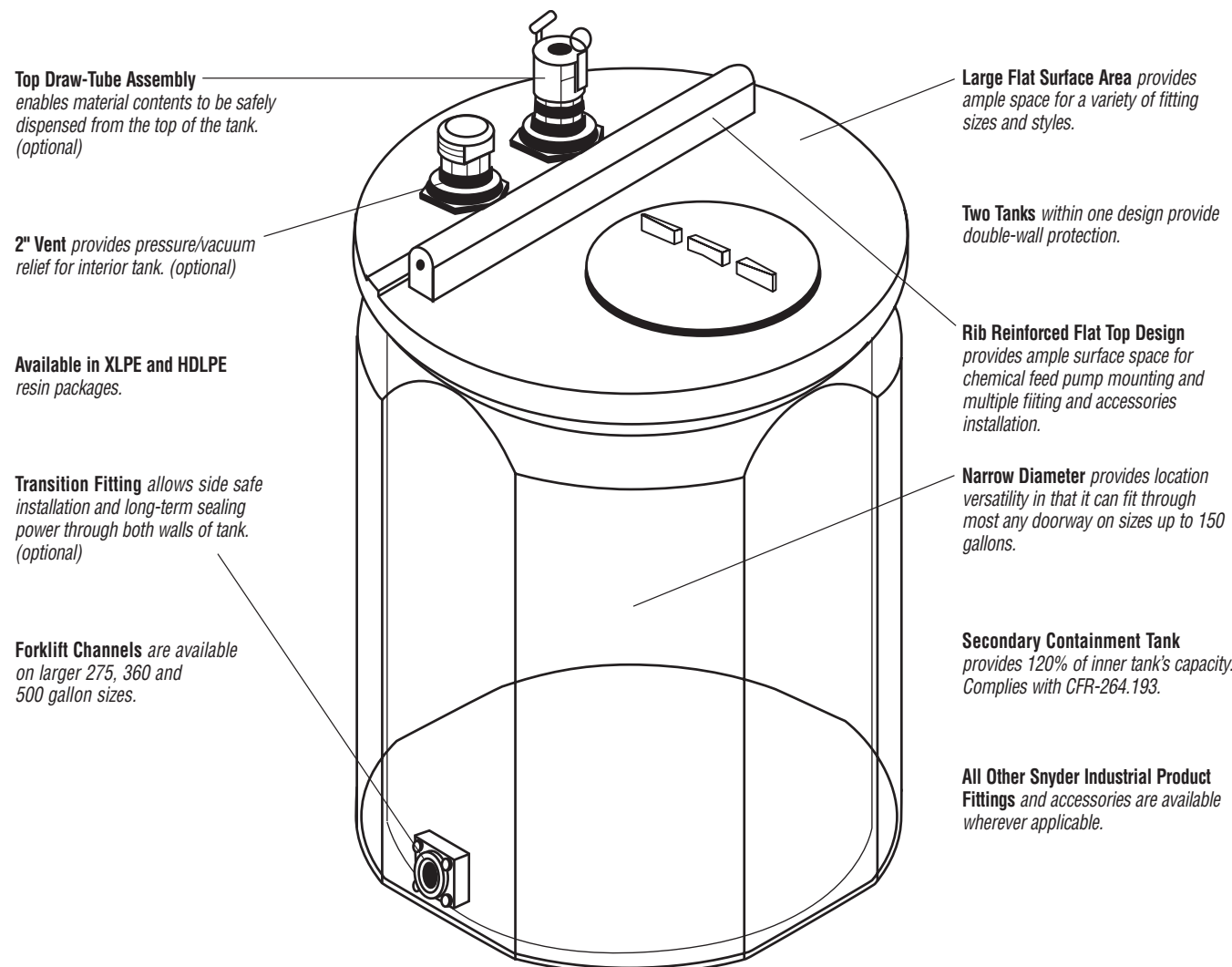

OPTIONS / ACCESSORIES



Hinged and Open Top Designs

Double-wall tank designs are available in different open top configurations for applications requiring greater access to tanks interior.



Forklift and Pallet Jack Accessible Designs

Larger 275, 360 and 500 gallon sizes are equipped with forklift channels designed to help move the containers when full and empty.

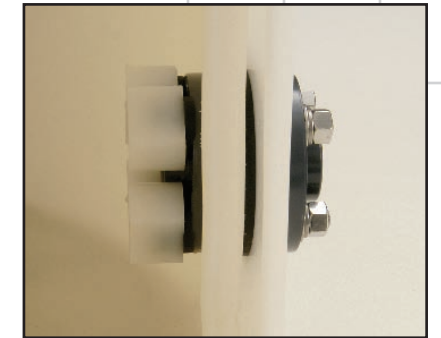

Transition Fitting

Allows side safe installation and long-term sealing power through both walls of tank.



Pump Pad

Provides added durability for metering pumps to be mounted on top of the tank system. (optional)



Stands

Double-wall tank systems can be mounted on elevation stands, creating more room for plumbing and other system requirements without utilizing additional floor space. (patent pending)



Other Fittings and Accessories

All applicable Snyder Industries fittings and accessories can be integrated to complete tank system.

Tank Material Options

High-density linear polyethylene (HDLPE) or cross-linked, high-density polyethylene (XLPE).

SPECIFICATIONS

Double-Wall Tank System

Part No.	Style	Gallons	Diameter	Height	Lid
1000200N97202L	DCT	35	21 3/4"	36"	6"
1000300N97202L	DCT	60	25 3/4"	41"	14"
598000N97202L	DCT	120	33 3/4"	50"	14"
1000400N97202L	DCT	150	33 3/4"	61"	14"
1000500N97202L	DCT	275	47"	60"	14"
1000600N97202L	DCT	360	53"	60 1/4"	14"
1000800N97202L	DCT	500	53"	78 1/2"	14"

NOTE: 12 larger double-wall tank sizes available up to 6,500 gallons.